

Earth Centre Doncaster UK

This landmark millennium project opened to the public in 1999. The £50 million visitor attraction and ecological parkland cover 160 hectares of a former colliery site in South Yorkshire.

The whole project is based around principles of energy efficiency, water conservation, recycling and use of non-polluting materials to provide the basis for sustainable development. It features a fully integrated network of water management that incorporates rainwater harvesting and the treatment, storage and recycling of water for use in irrigation and water features and as a wildlife habitat.

The scheme includes areas of productive woodland, ecological grasslands and wetlands arranged around a central area of innovative gardens. New gardens are based on organic horticultural principles and explore unusual associations of planting that offer benefits for shelter, wildlife, food and timber. Distinctive structures have been developed using a combination of local stone, green oak and steel to establish a unique contemporary character within the site that complements a historic surrounding landscape.

Site Area: 100 Hectares
Client: Earth Centre
Architects: Feilden Clegg Bradley Studios
 Alsop and Störmer
 Future Systems
Engineers: Arup
 Atelier One
 Atelier Ten
 Parker Associates
Quantity Surveyors: Bernard William Associates
Overall Project Value: £50 million

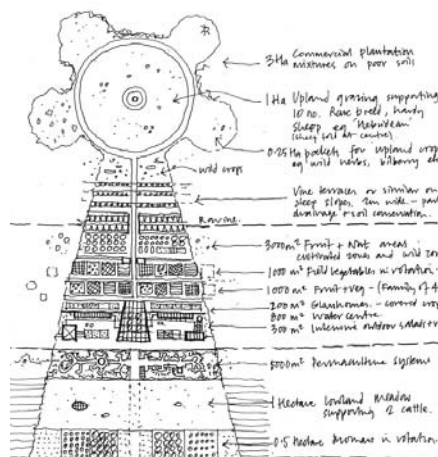
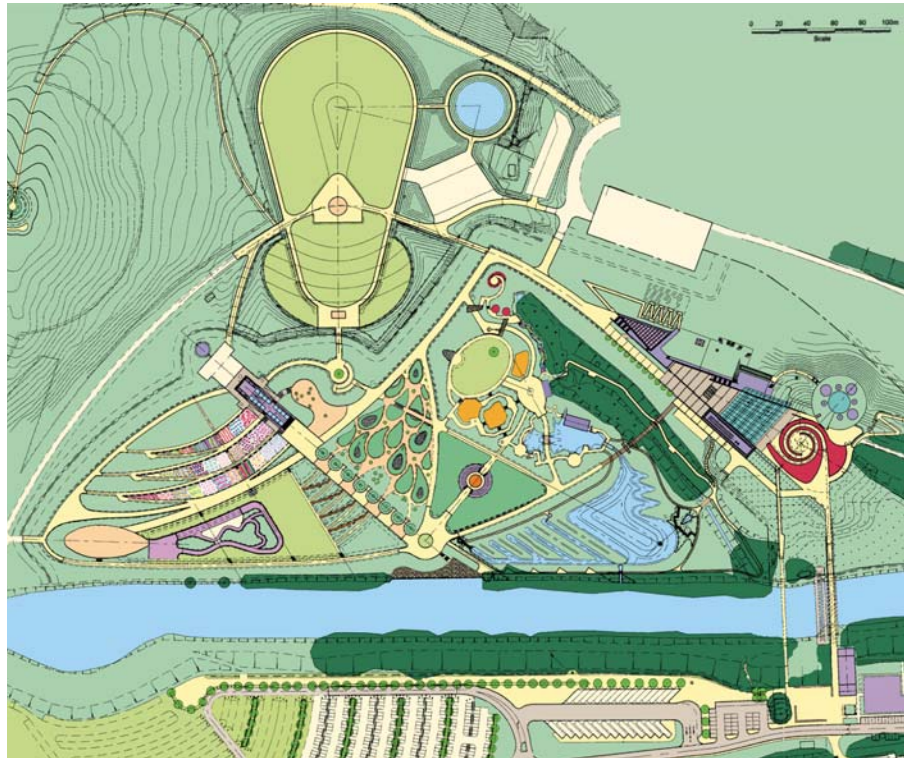

Top: Masterplan
 Above: The Living Machine
 Left: Grid shell; Horticultural diagram